

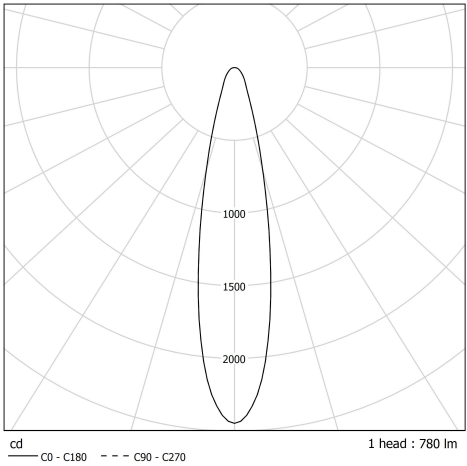

Description

MOD MONO spotlight on hook (Stefan Diez design). BRONZE finishing. Equipped with an interchangeable BLINDER collimator BRONZE finishing. Low-voltage head, diameter 100, can swivel through 360° thanks to a nickel-plated copper double hoop. Bronze anodised aluminium fin passive heat sink. Interchangeable tubular collimator in bronze anodised aluminium



Light specifications and controlling

- CoB LED Module 900 lm (without endcap), IRC>90, 2700 K, 3 SDCM
- Interchangeable optics unit composed of a mixing chamber and a Spot Beam 20° glass lens
- Constant Current Driver (non-dimmable)

Installation and maintenance

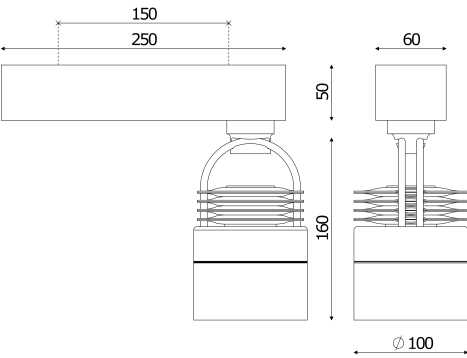

- Dimensions : Head : Ø100x160 mm, Box : 250x50x60 mm
- Box in anodised aluminium containing a 220-240 V 50/60 Hz power supply and a 3 x 2.5 mm² terminal block
- For surface mounting via 2 x M3 screws with centre distance 150 mm (not supplied).



Characteristics

- Warranty : 5 years
- 50 000 h L80/B10 at 25°C
- Operating temperature: -5 °C to +35 °C
- Protection : IP20
- Electrical class: Class I
- Power consumption: 13 W
- Photobiological hazard: Group 1
- Fire resistance: 850 °C
- Weight: 1,19 kg
- Designed and made in France and Germany